

MODEL : C16 - 16" (405mm) Concrete saw (AGP Europe)

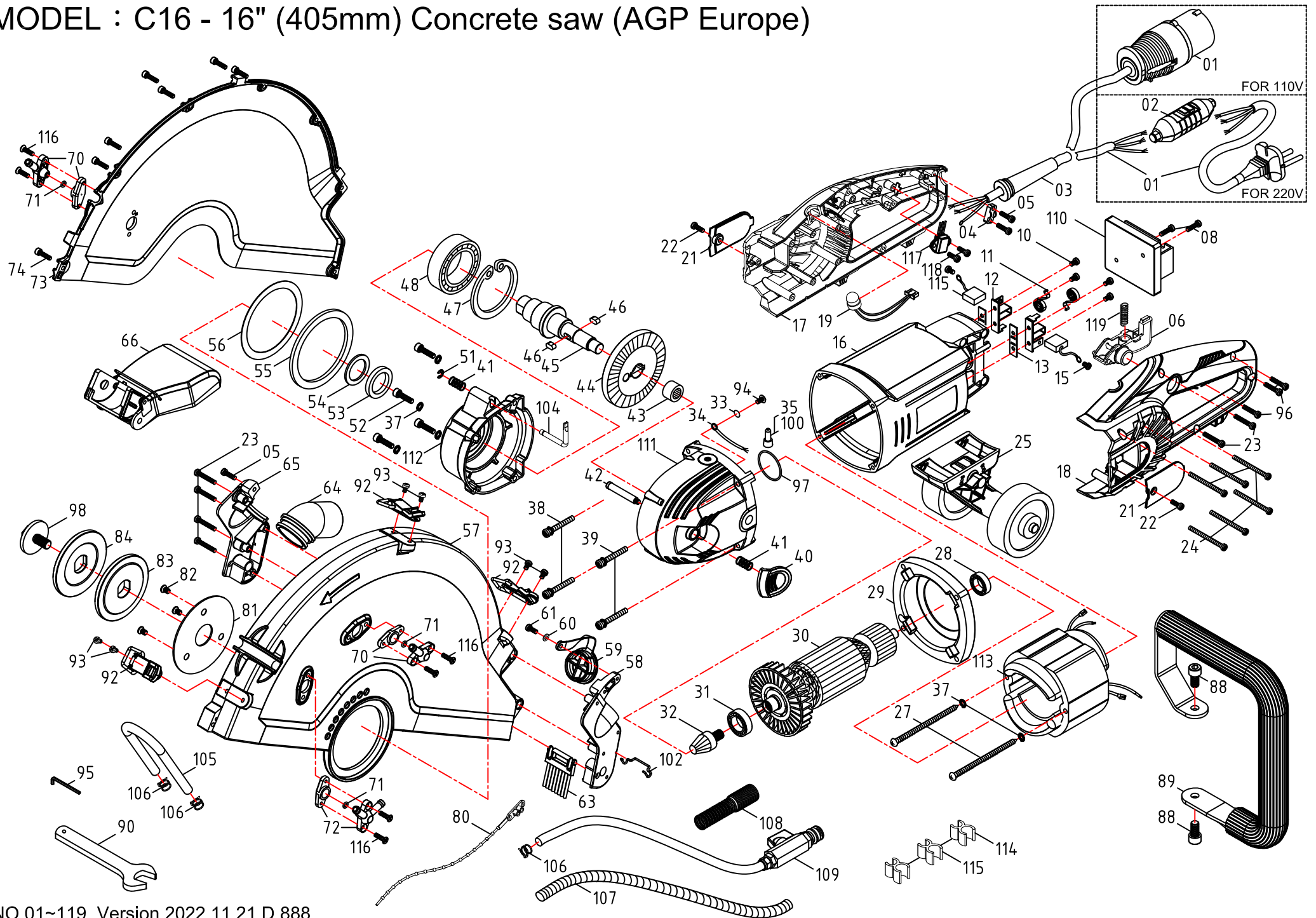

C16-220V(10203-016-206-4043-004-026)

C16 CONCRETE SAW

ARTICLE NO.	NO.	PARTS NAME	Q'TY	ARTICLE NO.	NO.	PARTS NAME	Q'TY
206-031503300-01	1	POWER SUPPLY CABLE (VDE-1.5x3Cx3M-H07RNF)	1	308-03006-000-001	56	PLASTIC RING (Ø74xØ91.5x0.25)	1
304-03013-004-008	2	PRCD INTERRUPTER PROTECTION (220V)	1	0299-0254-0001-002	57	UPPER BLADE COVER	1
303-02001-004-011	3	CORD ARMOR (Ø10.3)	1	303-01342-004-001	58	DUST PORT BRACKET-LEFT (BLACK)	1
303-01003-004-004	4	CABLE CLIP	1	303-02051-000-001	59	DUST PORT PLUG	1
403-M04014003-160	5	PANHEAD TAPPING SCREW-B (M4x14)	3	424-041010-10	60	FLAT WASHER (Ø4xØ10x1)	1
0299-0014-00164-026	6	SWITCH ACTUATOR (RED-187C)(LOCK-OFF)	1	403-M04010001-080	61	PANHEAD TAPPING SCREW-A (M4x10)	1
403-M04016003-160	8	PANHEAD TAPPING SCREW-B (M4x16)	2	203-0112-00004-001	63	BLADE GUARD BRUSH (BLACK)	1
403-M04016003-020	10	PANHEAD TAPPING SCREW-B (M4x16)	4	303-01082-004-001	64	DUST ATTACHMENT (BLACK)	1
302-04009-000-004	11	BRUSH SPRING (0.4x4x3T)	2	303-01342-004-002	65	DUST PORT BRACKET-RIGHT (BLACK)	1
307-02004-000-004	12	CARBON BRUSH HOLDER (7x17)	2	0299-0184-00000-002	66	SPLASH GUARD	1
303-01303-005-002	13	INSULATION PLATE (10x38x1)	2	0203-0113-00004-004	70	WATER NOZZLE ASSY.-R (BLACK)	2
407-M04006070-030	15	PANHEAD MACHINE SCREW (M4-0.7 x 6)	2	303-02009-004-089	71	O-RING (Ø4x1.5)	3
0203-0085-00026-044	16	MOTOR HOUSING (GRAY-RAL7016)	1	0203-0113-00004-003	72	WATER NOZZLE ASSY.-L (BLACK)	1
303-01065-026-001	17	HANDLE HALF-RIGHT (GRAY-RAL7016)	1	0201-0139-00001-018	73	OUTER BLADE COVER	1
303-01066-026-001	18	HANDLE HALF-LEFT (GRAY-RAL7016)	1	406-M04012070-080	74	SOCKET CAP SCREW (M4-0.7 x 12)	7
0299-0135-00000-003	19	LED INDICATOR LIGHT	1	423-00000-1	80	ZIP TIE (KTV-150BK)	1
303-01340-026-003	21	CARBON CAP (GRAY-RAL7016)	2	302-03227-903-001	81	RETAINING PLATE	1
403-M04012003-080	22	PANHEAD TAPPING SCREW-B (M4x12)	2	415-M05008080-000	82	FLAT HEAD MACHINE SCREW (M5-0.8 x 8)	3
403-M04025003-080	23	PANHEAD TAPPING SCREW-B (M4x25)	6	0202-0116-00903-002	83	INNER FLANGE (Ø25.4)	1
403-M04050001-080	24	PANHEAD TAPPING SCREW-A (M4x50)	6	302-04203-903-002	84	COUNTER FLANGE	1
0299-0177-00000-001	25	GUIDE ROLLER ASSY.	1	406-M08016125-170	88	SOCKET CAP SCREW (M8-1.25 x 16)	2
302-04529-000-001	27	PANHEAD TAPPING SCREW-A (M5x90)	2	202-0036-00902-003	89	FRONT HANDLE	1
302-05514-000-008	28	BALL BEARING (6200)	1	305-00302-004-002	90	WRENCH (M17)	1
303-01057-026-001	29	FAN BAFFLE (GRAY-RAL7016)	1	0299-0218-00000-001	92	TOGGLE LATCH	3
299-0001-23000-157	30	ARMATURE (220V-100x54.1x75)	1	407-M04006070-110	93	PANHEAD MACHINE SCREW (M4-0.7 x 6)	6
302-05516-000-002	31	BALL BEARING (6202)	1	405-M04010070-040	94	TRUSS HEAD MACHINE SCREW (M4-0.7 x 10)	1
302-06018-000-008	32	BEVEL PINION GEAR (M2.35x6T)	1	305-00010-901-006	95	HEX KEY (M3)	1
426-040000-00	33	EXTERNAL STAR WASHER (M4)	1	403-M04020001-160	96	PANHEAD TAPPING SCREW-A (M4x20)	3
306-01100720A035-01	34	WIRE LEAD (1007-20#35CM)	1	303-02009-004-090	97	O-RING (Ø35x1.5)	1
456-0	35	CRIMP CAP CONNECTOR (C4)	1	302-04414-000-002	98	BOLT (M10xP1.5)	1
425-050000-00	37	SPRING WASHER (M5)	6	302-04478-901-003	102	CLIP-FEMALE	1
403-M05045003-021	38	PANHEAD TAPPING SCREW-B-W/WASHER (M5x45)	2	302-04186-903-004	104	L-CLEVIS PIN	1
403-M05050003-021	39	PANHEAD TAPPING SCREW-B-W/WASHER (M5x50)	2	0205-0007-00000-027	105	TUBE (Ø6.4xØ10x0.2M)(GRAY)	1
203-0018-00004-002	40	SPINDLE LOCK BUTTON (BLACK)	1	302-04478-903-002	106	CLIP	3
302-04026-901-082	41	SPRING (Ø0.9xØ7.4xØ9.2x5Tx16L)	2	0205-0008-00000-018	107	CABLE PROTECTOR (Ø10x90CM)	1
302-04119-907-002	42	ARBOR LOCK	1	302-04502-903-002	108	SPRING	1
302-05532-000-001	43	NEEDLE BEARING (TA1212)	1	0299-0018-00000-055	109	WATER FEED CONNECTOR KIT	1
302-06015-000-032	44	BEVEL GEAR (M2.35x37T)	1	0299-0239-00000-009	110	ELECTRONICS UNIT (220V)	1
302-04003-000-123	45	SPINDLE (M10xP1.5-116.6MM)	1	201-0002-00001-164	111	GEAR HOUSING (MATTE SILVER)	1
421-05010-10	46	PARALLEL KEY (5x5x10)	2	201-0003-00001-079	112	GEAR PLATE (MATTE SILVER)	1
422-R62-0	47	INTERNAL CIRCLIP (R-62)	1	299-0002-20000-199	113	STATOR (220V-100x54.1x75)	1
302-05520-000-003	48	BALL BEARING (6206)	1	303-01299-000-003	114	HOSE JOINER (BLACK-Ø10xØ14.4)	3
422-E05-1	51	E-CLIP (E-5)	1	305-00001-000-035	115	CARBON BRUSH (7x17x19)(220V)	2
406-M05025080-160	52	SOCKET CAP SCREW (M5-0.8 x 25)	4	413-M04014003-080	116	FLAT HEAD TAPPING SCREW-B (M4x14)	6
303-02002-004-042	53	OIL SEAL (Ø25xØ35x5)	1	204-0025-00000-004	117	HALL EFFECT SWITCH	1
308-03001-000-008	54	FELT OILER (Ø25xØ35x2.5)	1	403-M04012003-020	118	PANHEAD TAPPING SCREW-B (M4x12)	2
303-02065-004-001	55	RUBBER FENDER (Ø75xØ91x3.5)	1	302-04171-000-001	119	SPRING (Ø0.8 x Ø6.4 x Ø8 x 9T x 26L)	1