

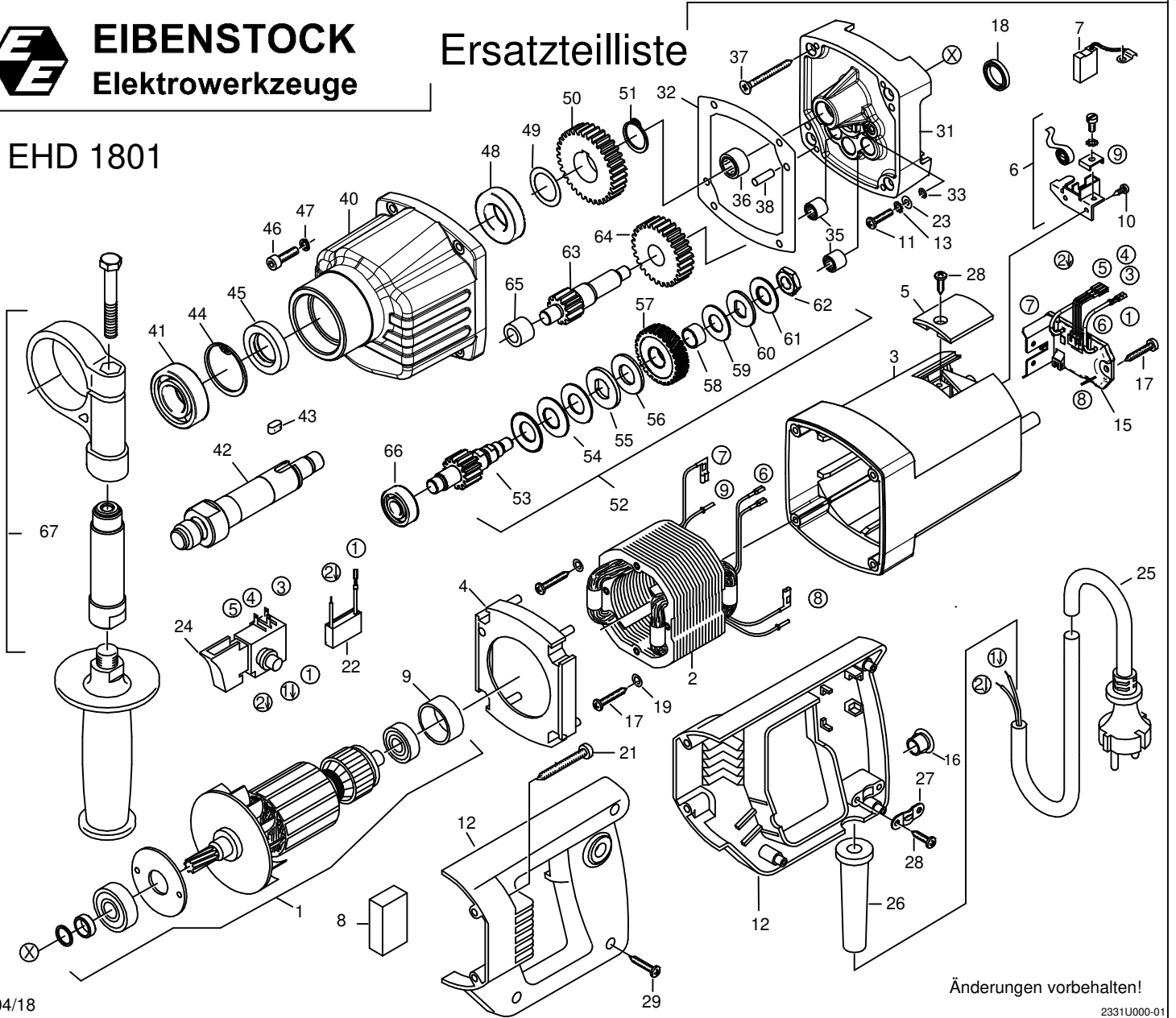

EIBENSTOCK
Elektrowerkzeuge

Ersatzteilliste

EHD 1801



Änderungen vorbehalten!

0331U000 - EHD_1801 Version: 01

as of serial no. 13 00 91

Pos.	Description	Item No.	pc.	Pos.	Description	Item No.	pc.
1	Rotor, compl. 230V	7331U100	1	55	Driving washer	73430499	1
2	Stator, compl. 230V	7142B150	1	56	Brass washer 28,5x14,1x2	85000084	1
3	Motor housing	80900069	1	57	Clutch wheel	7331H550	1
4	Air guiding ring	80900072	1	58	Cylinder bearing 1208 T	80420240	1
5	Brush cover	80900073	2	59	Bronze disc 25x12,1x1	85000083	1
6	Brush holder, compl.	80201199	2	60	Driving washer	73116496	1
7	Carbon brush 6,3x16x20	80700019	2	61	Disc spring 25x12,2x0,9	80200710	1
8	Foam filler	80600306	1	62	Nut M10x1	80201007	1
9	Bearing cap	83000031	1	63	Intermediate shaft 2	7331J500	1
10	Screw 2,9x13	80201252	4	64	Intermediate wheel	7331J470	1
11	Screw M4x16	80201131	2	65	Needle sleeve DL1012	80420116	1
12	Pair of handle halves	80900070	1	66	Grooved ball bearing 6000	80410020	1
13	Tooth lock washer 4,3	80200752	2	67	Side handle, compl.	7332L695	1
15	Printed circuit board 230V	80601135	1				
16	Plug	80900012	1				
17	Screw 4,2x25	80201273	4				
18	Shaft seal 15x21x3	83000042	1				
19	Lock washer S6	80201362	2				
21	Screw 4,8x45	80201267	4				
22	Capacitor	73320305	1				
23	Washer 4,3	80201371	2				
24	Switch	80600116	1				
25	Connecting cable 2x1mm ² 3m	80600060	1				
26	Cable grommet	83000004	1				
27	Wire locking flange	85000020	1				
28	Screw 4,2x13	80201270	4				
29	Screw 4,2x22	80201272	3				
31	End shield of gearing	7331U610	1				
32	Gearbox seal	82000501	1				
33	O-ring 3,68x1,78	83000019	2				
35	Needle sleeve HK0810	80420110	2				
36	Needle sleeve HK1210B	80420131	1				
37	Screw 4,5x50	80201275	4				
38	Grooved pin 5x12	80200584	2				
40	Gearbox housing	7331H400	1				
41	Grooved ball bearing 6004 2RS	80410051	1				
42	Work spindle	7331H420	1				
43	Parallel key 6x6x11	73430496	1				
44	Retaining ring 35x1,5	80201334	1				
45	Shaft seal 20x35x7	83000034	1				
46	Screw M5x20	80201121	4				
47	Spring lock washer 5	80201302	4				
48	Grooved ball bearing 6904 2RS	80410152	1				
49	Fitting washer 20x28x0,1	80200509	1				
50	Spindle wheel	7331J430	1				
51	Retaining ring 20x1,2	80201324	1				
52	Clutch, compl.	7331U493	1				
53	Intermediate Shaft 1	7331J490	1				
54	Disc spring 28x14,2x1,25	80200715	3				