

Kernbohrständer TYP KS 50 (E, S) Drill Rig TYPE KS 50 (E, S)

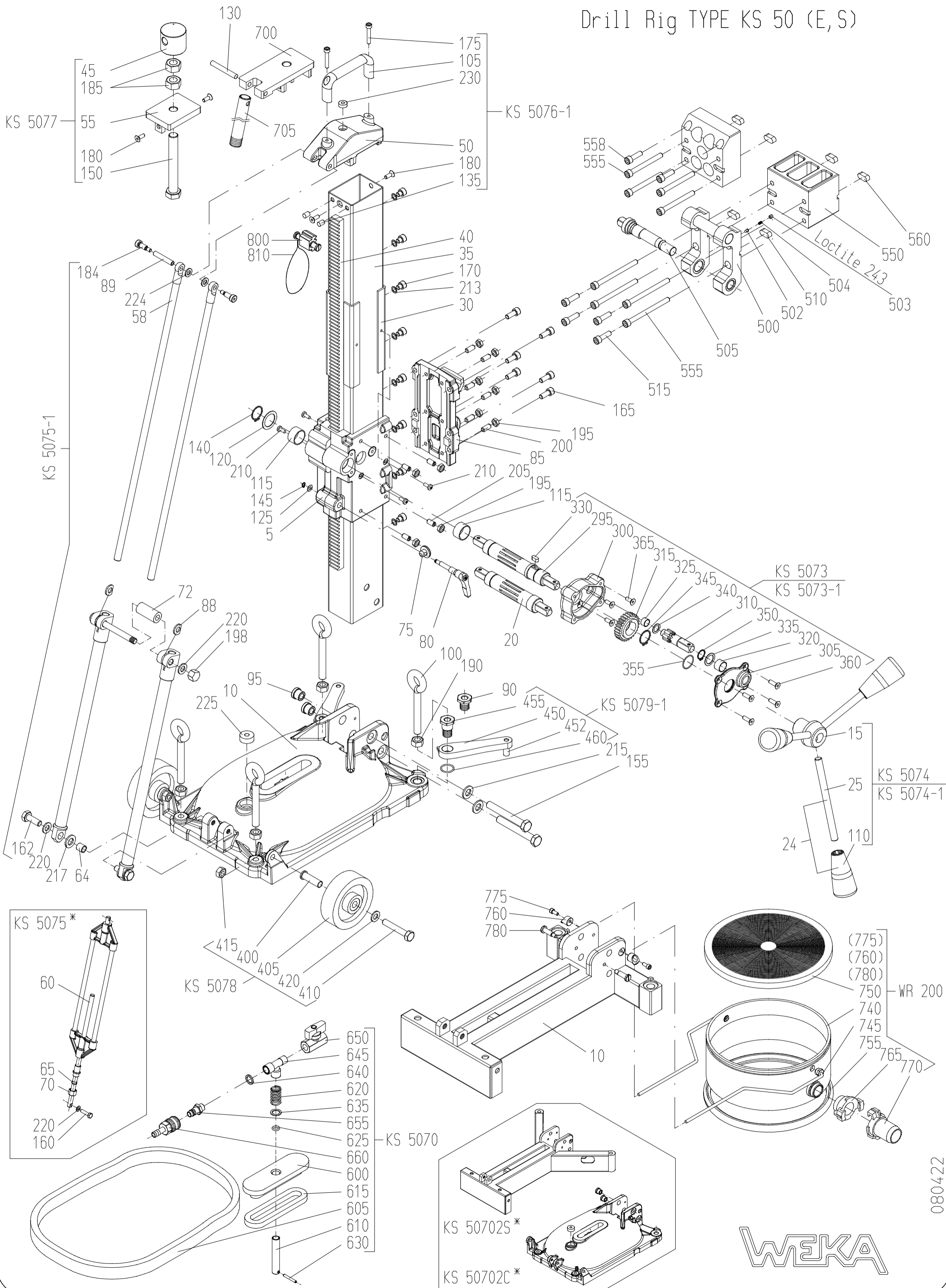

**Spare Parts Price List - Diamond Core Drill Rig
Type KS 50, KS 50 E**

EPE-KS50

| FIG | NO | DESCRIPTION | STANDARD | TYPE | PART NO |
|-----|----|--|--------------|-----------------|--------------|
| 5 | 1 | Feed case incl. bearing bushes | | | KS50701C |
| 10 | 1 | Base plate cpl. without swing feet, without eye screws | | KS50, E, L, LL | KS50702EC-1 |
| | 1 | Base plate cpl. with swing feet, without eye screws | | KS50 | KS50702C-1 |
| | 1 | Steel foot cpl. with eye screws, with swing feet | | KS50S | KS50702S-1C |
| | 1 | Steel foot cpl. with eye screws, without swing feet | | KS50ES, SL, SLL | KS50702ES-1C |
| | 1 | Steel foot cpl. with eye screws, without swing feet | | KS50SXL, XXL | KS50702SXL |
| 15 | 1* | Feed hub | | square-13 | KS50703 |
| | 1 | Feed hub | | hexagon-17 | KS50703-1 |
| 20 | 1* | Feed pinion cpl. | | square-13 | KS50704EC |
| | 1 | Feed pinion cpl. | | hexagon-17 | KS50704EC-1 |
| 24 | 3 | Feed lever cpl. with cylinder knob | | | KS13706C |
| 25 | 3 | Feed lever | | | KS13706 |
| 30 | 4 | Guide angle | | | KS50708 |
| 35 | 1 | Stand column | | KS50/S | KS50710 |
| | 1 | Stand column | | KS50E/ES | KS50710E |
| | 1 | Stand column | | KS50/S L | KS50710.12 |
| | 1 | Stand column | | KS50/S LL | KS50710.16 |
| | 1 | Stand column | | KS50XL | KS50710.23 |
| | 1 | Stand column | | KS50XXL | KS50710.30 |
| 40 | 1 | Gear rack | | KS50/S, | KS50711 |
| | 1 | Gear rack | | KS50/S L | KS50711.12 |
| | 1 | Gear rack | | KS50/S LL | KS50711.16 |
| | 1 | Gear rack | | KS50XL | KS50711.23 |
| | 1 | Gear rack | | KS50XXL | KS50711.30 |
| 45 | 1 | Chuck head | | | KS50712 |
| 50 | 1 | Column head cpl. with water level | | KS50/S | KS50713C-1 |
| | 1 | Column head cpl. with water level | | KS50E/ES,L- | KS50713.3-1C |
| 55 | 1 | Head plate | | KS50E/ES | KS50713E |
| 58 | 2 | Rod with joint piece | | KS50/S | KS50714C-1 |
| 60 | 1* | Rod long | | | KS50715 |
| 64 | 2 | Distance Sleeve | | | KS50719 |
| 65 | 1* | Locking sleeve | | | KS13720 |
| 70 | 1* | Locking nut | M20x1,5 | | KS13722 |
| 72 | 1 | Distance Sleeve | | | KS50724 |
| 75 | 1 | Holding plate | | | KS50728 |
| 80 | 1 | Clamping shaft cpl. | | | KS50729C |
| 85 | 1 | Front plate incl. bearing bush | | | KS50740C |
| 88 | 2 | Distance disc | | | KS50754 |
| 89 | 1 | Distance pin | | | KS50755 |
| 90 | 2 | Threaded bushing | | KS50E/ES,L- | KS50772E-1 |
| | 2* | Threaded bushing | | | KS50772E |
| 95 | 2 | Threaded bushing | | KS50/S | KS50776 |
| 100 | 4 | Eye screw | | | KS50782 |
| | 4 | Eye screw | | | KS50782S |
| 105 | 1 | Carrying handle | | | DK30105 |
| 110 | 3 | Cylinder knob | | | 2812080 |
| 115 | 2 | Bearing socket | | | 6625015 |
| 120 | 1 | Shim ring | 25x35x1/988 | | 1925351 |
| 125 | 1 | Shim ring | 6x12x0,5/988 | | 1906125 |
| 130 | 1 | Parallel pin | 8x60/7 | KS50ER | 2508060 |
| 135 | 2 | Parallel pin | | | KS50779 |
| 140 | 1 | Retaining ring | 25x1,2/471 | | 3525012 |
| 145 | 1 | Retaining ring | 6x0,7/471 | | 3506007 |
| 150 | 1 | Hexagon head screw | M16x120/933 | | 0616120 |
| 155 | 2 | Hexagon head screw | M12x90/931 | | 0612090 |
| 160 | 1* | Hexagon head screw | M10x40/931 | | 0610040 |
| 162 | 2 | Hexagon head screw | M10x30/933 | | 0610030 |
| 165 | 6 | Hexagon socket head screw | M8x20/912 | | 0108020 |
| 170 | 8 | Hexagon socket head screw | M8x8/912 | KS50 | 0108008 |
| | 8 | Hexagon socket head screw | M8x10/912 | KS50E | 0108010 |
| | 11 | Hexagon socket head screw | M8x10/912 | KS50L | 0108010 |
| | 15 | Hexagon socket head screw | M8x10/912 | KS50LL | 0108010 |
| | 21 | Hexagon socket head screw | M8x10/912 | KS50XL | 0108010 |
| | 27 | Hexagon socket head screw | M8x10/912 | KS50XXL | 0108010 |
| 175 | 2 | Hexagon socket head screw | M6x35/912 | | 0106035 |

Spare Parts Price List - Diamond Core Drill Rig Type KS 50, KS 50 E Accessories

| FIG | NO | DESCRIPTION | STANDARD | TYPE | PART NO |
|-----|----|--------------------|------------|---------|---------|
| 180 | 2 | Counter sunk screw | M6x16/7991 | | 0406016 |
| 184 | 2 | Cap shoulder screw | M6x16 | | 0506016 |
| 185 | 2 | Hexagon nut | M16/934 | | 1016934 |
| 190 | 4 | Hexagon nut | M12/934 | | 1012934 |
| 195 | 10 | Hexagon nut | M8/936 | | 1008936 |
| 198 | 1 | Hexagon Cap Nut | M10 | | 1010917 |
| 200 | 6 | Set screw | M8x18/551 | | 0708018 |
| 205 | 4 | Set screw | M8x16/551 | | 0708016 |
| 210 | 4 | Raised head screw | M5x12/7985 | | 0305012 |
| 213 | 8 | Locking Washer | SM8 | KS50/E | 1808000 |
| | 11 | Locking Washer | SM8 | KS50L | 1808000 |
| | 15 | Locking Washer | SM8 | KS50LL | 1808000 |
| | 21 | Locking Washer | SM8 | KS50XL | 1808000 |
| | 27 | Locking Washer | SM8 | KS50XXL | 1808000 |
| 215 | 2 | Medium washer | A13/125 | | 1813025 |
| 217 | 2 | Medium washer (PA) | A13/125 | | 1813250 |
| 220 | 1 | Medium washer | A10,5/125 | | 1810125 |
| 224 | 2 | Medium washer (PA) | A8,4/125 | | 1808160 |
| 225 | 1 | Tin water level | | | 7500025 |
| 230 | 1 | Tin water level | | | 7500015 |

Fine Feed

| FIG | NO | DESCRIPTION | STANDARD | TYPE | PART NO |
|-----|----|----------------------------------|-------------|------------|------------|
| | 1* | Fine feed cpl. incl. Feed pinion | | square-13 | KS5073 |
| | 1 | Fine feed cpl. incl. Feed pinion | | hexagon-17 | KS5073-1 |
| 295 | 1* | Feed pinion cpl. | | square-13 | KS50704C |
| | 1 | Feed pinion cpl. | | hexagon-17 | KS50704C-1 |
| 300 | 1* | Gear box | | square-13 | KS50725 |
| | 1 | Gear box | | hexagon-17 | KS50725-1 |
| 305 | 1* | Gear box cover | | square-13 | KS50726 |
| | 1 | Gear box cover | | hexagon-17 | KS50726-1 |
| 310 | 1* | Pinion shaft cpl. | | square-13 | KS50705C |
| | 1 | Pinion shaft cpl. | | hexagon-17 | KS50705C-1 |
| 315 | 1 | Spur wheel | | | KS50707 |
| 320 | 1* | Bearing socket | 17x19x12 | square-13 | 6617012 |
| | 1 | Bearing socket | 20x23x10 | hexagon-17 | 6620010 |
| 325 | 1 | Bearing socket | 12x14x8 | | 6614008 |
| 330 | 1 | Parallel key | 6x6x14 | | 3006014 |
| 335 | 1* | Shim ring | 17x24x1/988 | square-13 | 1917241 |
| | 1 | Shim ring | 20x28x1/988 | hexagon-17 | 1920281 |
| 340 | 1 | Shim ring | 12x18x1/988 | | 1912181 |
| 345 | 1 | Retaining ring | 25x1,2/471 | | 3525012 |
| 350 | 1* | Retaining ring | 17x1/471 | square-13 | 3517001 |
| | 1 | Retaining ring | 20x1,2/471 | hexagon-17 | 3520012 |
| 355 | 1 | O-Ring | 25x1,5 | | 5525015 |
| 360 | 4 | Counter sunk screw | M6x20/7991 | | 0406020 |
| 365 | 3 | Counter sunk screw | M6x16/7991 | | 0406016 |

Wheet set

| FIG | NO | DESCRIPTION | STANDARD | TYPE | PART NO |
|-----|----|--------------------|--------------|------|---------|
| | | Wheel set cpl. | | | KS5078 |
| 400 | 2 | Wheel sleeve | | | KS50775 |
| 405 | 2 | Wheel | 100x12x30/50 | | 9810012 |
| 410 | 2 | Hexagon head screw | M10x60/931 | | 0610060 |
| 415 | 2 | Hexagon nut | M10/934 | | 1010934 |
| 420 | 2 | Medium washer | A10,5/125 | | 1810125 |

Swing feet set

| FIG | NO | DESCRIPTION | STANDARD | TYPE | PART NO |
|-----|----|------------------------------|----------|--------|-----------|
| | * | Swing feet set cpl. | | | KS5079 |
| | | Swing feet set cpl. | | | KS5079-1 |
| | | Swing feet set cpl. | | KS50/S | KS5079S-1 |
| 450 | 2* | Swing foot with parallel pin | | | KS50770C |
| | 2 | Swing foot | | | KS30770 |
| 452 | 2 | Swing foot pin | | | KS50771 |
| | 2 | Swing foot pin | | KS50/S | KS50771S |
| 455 | 2* | Swing foot bushing | | | KS50772 |
| | 2 | Swing foot bushing | | | KS50772-1 |

| | | | | | |
|-----|----|--------|------|--|---------|
| 460 | 2* | O-Ring | 20x3 | | 5520003 |
| | 2 | O-Ring | 20x2 | | 5520002 |

Spare Parts Price List - Diamond Core Drill Rig Type KS 50, KS 50 E Accessories

Machine adaptor

| FIG | NO | DESCRIPTION | STANDARD | TYPE | PART NO |
|-----|----|---------------------------|-----------|------------|------------|
| 500 | 1* | Machine adaptor | | square-13 | KS50745C |
| | 1 | Machine adaptor | | hexagon-17 | KS50745-1C |
| 505 | 1* | Excentric shaft | | square-13 | KS50748 |
| | 1 | Excentric shaft | | hexagon-17 | KS50748-1 |
| 510 | 2 | Parallel key | 10x8x22 | | 3010022 |
| 515 | 4 | Hexagon socket head screw | M8x25/912 | | 0128025 |

Distance plate

| FIG | NO | DESCRIPTION | STANDARD | TYPE | PART NO |
|-----|----|--|------------|----------------|------------|
| 550 | 1 | Distance plate cpl. with fig. 555 and 560 | | DK2-5 SR2-3 | KS50738C |
| | 1 | Distance plate cpl. with fig. 555, 558 and 560 | | SR65 | KS50738.6C |
| 555 | 4 | Hexagon socket head screw | M8x105/912 | DK2-5 SR2-3 | 0108105 |
| | 4 | Hexagon socket head screw | M8x70/912 | SR65 | 0108070 |
| 558 | 2 | Hexagon socket head screw | M8x25/912 | SR65 | 0128025 |
| 560 | 2 | Parallel key | 10x8x22 | | 3010022 |

Vacuum Adapter

| FIG | NO | DESCRIPTION | STANDARD | TYPE | PART NO |
|-----|----|---|-------------|------|----------|
| | 1 | Vacuum adaptor cpl. incl. Item 605 | | | KS5070 |
| | 1 | Vacuum adapter cpl. excl. Vacuum seal incl. Item 600, 610-660 | | | KS50730C |
| 600 | 1 | Vacuum adaptor plate | | | KS50730 |
| 605 | 1 | Vacuum seal | | | KS50732 |
| 610 | 1 | Suction pipe | | | KS10735 |
| 615 | 1 | Sealing ring | | | KS10750 |
| 620 | 1 | Pressure spring | | | 4320030 |
| 625 | 1 | Shim ring | PS13x19x1 | | 1913191 |
| 630 | 1 | Spring type straight pin | 4x30 | | 2404030 |
| 635 | 1 | O-Ring | 11x2,5 | | 5511025 |
| 640 | 1 | Sealing ring | G1/4" | | 7014003 |
| 645 | 1 | T-Thread piece | G1/4" | | 7014020 |
| 650 | 1 | Ball valve | G1/4" | | 7014001 |
| 655 | 1 | Quick connect nipple | G1/4"xDN7,2 | | 7014025 |
| 660 | 1 | Quick connect socket | DN7,2x9 | | 7014030 |

Brace E

| FIG | NO | DESCRIPTION | STANDARD | TYPE | PART NO |
|-----|----|--------------------|-------------|--------|----------|
| | 1 | Brace E cpl. | | KS50ER | KS5075E |
| 700 | 1 | Head plate | | KS50ER | KS50713R |
| 705 | 1 | Supporting tube | | KS50ER | KS50716R |
| 45 | 1 | Chuck head | | | KS50712 |
| 60 | 1 | Rod long | | | KS50715 |
| 65 | 1 | Locking sleeve | | | KS13720 |
| 70 | 1 | Locking nut | M20x1,5 | | KS13722 |
| 130 | 1 | Parallel pin | 8x60/7 | | 2508060 |
| 135 | 2 | Parallel pin | | | KS50779 |
| 150 | 1 | Hexagon head screw | M16x120/933 | | 0616120 |
| 160 | 1 | Hexagon head screw | M10x40/931 | | 0610040 |
| 180 | 2 | Counter sunk screw | M6x16/7991 | | 0406016 |
| 185 | 2 | Hexagon nut | M16/934 | | 1016934 |
| 220 | 1 | Medium washer | A10,5/125 | | 1810125 |

Water Collecting Ring

| FIG | NO | DESCRIPTION | STANDARD | TYPE | PART NO |
|-----|----|------------------------------------|-----------|------|----------|
| | 1 | Water Collecting Ring cpl. | | | WR200 |
| 740 | 1 | Water Collecting Ring | | | WR20402C |
| 745 | 2 | Tension Spring | | | WR20406C |
| 750 | 1 | Seal Disk | | | WR20410 |
| 755 | 1 | Seal Ring | | | WR20750 |
| 760 | 2 | Catching Bush | | | KS50778 |
| 765 | 1 | Thread Coupling | | | 7034500 |
| 770 | 1 | Hose Coupling | ø32 | | 7000532 |
| 775 | 2 | Hex. Soc. Head Screw | M5x12/912 | | 0105012 |
| 780 | 2 | Slotted Pan Head Screw w. Shoulder | M6x20/923 | | 0306020 |

Track Stop

| FIG | NO | DESCRIPTION | STANDARD | TYPE | PART NO |
|------------|-----------|--------------------|-----------------|-------------|----------------|
| 800 | 1 | Track Stop cpl. | | | KS50430C |
| 810 | 1 | Tension Rubber | | | KS50432C |

Spare Parts Price List - Diamond Core Drill Rig Type KS 50, KS 50 E Assembly

Feed case cpl. without feed wheel, without fine feed

| FIG | NO | DESCRIPTION | STANDARD | TYPE | PART NO |
|-----|----|--|----------|------------|-------------|
| 910 | 1 | Feed case cpl. without feed wheel, without fine feed | | hexagon-17 | KS5072E-1 |
| | | including | | | |
| | 1 | Feed case incl. bearing bushes | | | KS50701C |
| | 1 | Feed pinion cpl. (hexagon-17) | | | KS50704EC-1 |
| | 4 | Guide angle | | | KS50708 |
| | 1 | Holding plate | | | KS50728 |
| | 1 | Clamping shaft cpl. | | | KS50729C |
| | 1 | Front plate incl. bearing bush | | | KS50740C |
| | 1 | Shim ring | | | 1925351 |
| | 1 | Shim ring | | | 1906125 |
| | 1 | Retaining ring | | | 3525012 |
| | 1 | Retaining ring | | | 3506007 |
| | 8 | Hexagon socket head screw | | | 0108020 |
| | 10 | Hexagon nut | | | 1008936 |
| | 4 | Threaded pin | | | 0708016 |
| | 6 | Threaded pin | | | 0708018 |
| | 4 | Counter sunk screw | | | 0305012 |
| 912 | 1 | Feed case BA cpl. without feed wheel, without fine feed like Fig.910 but prepared for automatic feed BA50 | | hexagon-17 | KS5072EBA-1 |
| 915 | 1 | Feed case cpl. without feed wheel, Fig.910 but with fine feed | like | hexagon-17 | KS5072-1 |
| 920 | 1 | Feed case BA cpl. without feed wheel, with fine feed Fig.915 but prepared for automatic feed BA50 | like | hexagon-17 | KS5072BA-1 |

Feed wheel cpl.

| FIG | NO | DESCRIPTION | STANDARD | TYPE | PART NO |
|-----|----|---|----------|------------|----------|
| 925 | 1* | Feed wheel cpl. (square-13) | | square-13 | KS5074 |
| | | including | | | |
| | 1 | Feed hub | | | KS50703 |
| | 3 | Feed lever | | | KS13706 |
| | 3 | Cylinder knob | | | 2812080 |
| 930 | 1 | Feed wheel cpl. (hexagon-17) like Fig.25, but with KS50703-1 | | hexagon-17 | KS5074-1 |

Brace cpl.

| FIG | NO | DESCRIPTION | STANDARD | TYPE | PART NO |
|-----|----|-------------|----------|---------|-------------|
| 940 | 1 | Brace cpl. | | KS50/S | KS5075-1 |
| | | | | KS50L | KS5075.12-1 |
| | | | | KS50LL | KS5075.16-1 |
| | | | | KS50XL | KS5075.23 |
| | | | | KS50XXL | KS5075.30 |

Column head cpl.

| FIG | NO | DESCRIPTION | STANDARD | TYPE | PART NO |
|-----|----|--|------------|-----------------------|------------|
| 945 | 1 | Column head cpl. | | KS50/S | KS5076-1 |
| | | including | | | |
| | 1 | Column head cpl. | KS50713C-1 | | |
| | 2 | Parallel pin | KS50779 | | |
| | 1 | Carrying handle | DK30105 | | |
| | 2 | Hexagon socket head screw | 0106035 | | |
| | 2 | Counter sunk screw | 0406016 | | |
| 946 | 1 | Column head cpl. Fig.945, but with KS50713.3-1C | like | KS50E,L,LL,XL, XXL | KS5076.3-1 |

Head plate cpl. (steel)

| FIG | NO | DESCRIPTION | STANDARD | TYPE | PART NO |
|-----|----|-------------------------|----------|----------|---------|
| 950 | 1 | Head plate cpl. (Steel) | | KS50E/ES | KS5077 |
| | | including | | | |
| | 1 | Head plate | KS50713E | | |
| | 1 | Chuck head | KS50712 | | |
| | 1 | Hexagon head screw | 0616120 | | |
| | 2 | Counter sunk screw | 0406016 | | |
| | 2 | Hexagon nut | 1016934 | | |

* parts are substituted

The prices listed are gross prices in € per item, plus statutory Value added tax.

When ordering spare parts, please always state: machine number, quantity, designation, spare part number and, for electrical parts, the nominal voltage (if different from 230 V).

WEKA Elektrowerkzeuge KG, Auf der Höhe 20, D 75387 Neulach - Altbulach
Telephon: +49 7053 96816-0, spare parts: +49 7053 96816-14 · Telefax: +49 7053 3138
Internet: www.weka-elektrowerkzeuge.de · E-mail: weka@weka-elektrowerkzeuge.de

Subject to change