

Frequenz - Umformer TYP FU 15 (D)
 Frequency - Converter TYP FU 15 (D)

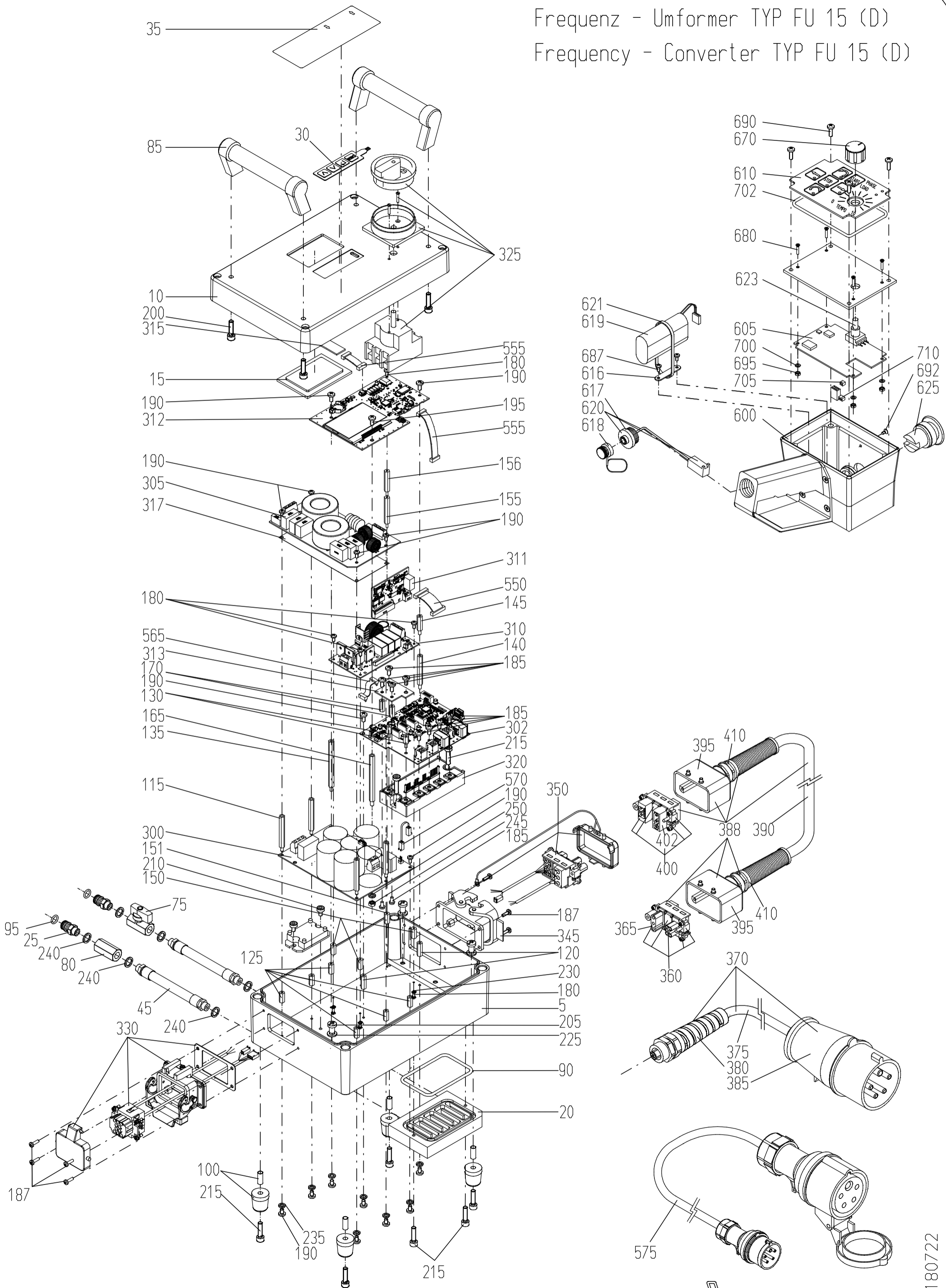

WEKA

Spare Parts List
Frequency Converter Type FU 15D - Mechanical Parts

EPE-FU15D

POS	ST	BENENNUNG	SACHNR	TYP / DATUM	E.-TEILNR.
5	1	FC-Box with pos. 20, 90, 215			FU15501C
10	1	Box Cover			FU15502-1C
15	1	Display Pane			FU06572
20	1	Cooling Plate			FU15506-2
25	2	Quick Connect Nipple			DK20225
30	1	Keypad			FU06570
35	1	Front Shield			FU15602D
45	2	Hose Piece cpl. with nipples			DK30235
75	1	Ball Valve			7014001
80	1	Socket			7014026
85	2	Carrying Handle	140-M6		8914060
90	1	O-Ring	RDR90x4		5590004
95	1	O-Ring	RDR11x2,5		5511025
100	4	Rubber foot with spacer sleeve	24,5x25x5,5		2824255
115	4	Hexagon spacer bolt	M4x60 i/a		1504602
120	2	Hexagon spacer bolt	M4x22 i/a		1504221
125	6	Hexagon spacer bolt	M4x16 i/a		1504161
130	2	Hexagon spacer bolt	M4x12 i/a		1504122
135	1	Hexagon spacer bolt	M4x80 i/a		1504802
140	1	Hexagon spacer bolt	M4x50 i/a		1504502
145	1	Hexagon spacer bolt	M4x24i/a		1504224
150	4	Hexagon spacer bolt	M3x16i/a		1503161
155	1	Hexagon spacer bolt	M3x60i/a		1503602
156	1	Hexagon spacer bolt	M3x20i/a		1503202
165	1	Hexagon spacer bolt	M5x80i/a		1505802
170	2	Hexagon spacer bolt	M4x18i/i		1504181
180	8	Cross recess cheese head screw	M3x8		0303008
185	10	Cross recess cheese head screw	M4x10 PH		0304011
187	8	Cross recess cheese head screw	M4x10 PH		0304010
190	16	Cross recess cheese head screw	M4x8		0304008
195	1	Cross recess cheese head screw	M5x8		0305008
200	4	Hex. Socket Head Screw	M6x20		0106120
205	3	Cross recess cheese head screw	M6x8		0306008
215	6	Hex. Socket Head Screw	M5x20		0105020
225	3	Spring Lock Washer	A6		1806128
230	4	Sealing Ring	M3		1803001
235	8	Sealing Ring	M4		1804001
240	6	Sealing Ring	G1/4"		7014003

Spare Parts List Frequency Converter Type FU15D - Electrical Parts

POS	ST	BENENNUNG	SACHNR	TYP / DATUM	E.-TEILNR
300	1	Inverter Board			FU15512
302	1	Logic Board	remote control		FU15518F-1
305	1	Power Supply Board			FU15514
310	1	Feed Board			FU15516.48
311	1	Feed Board Logic			FU15517
312	1	Display Board			FU15520
313	1	Adapter board intermediate circuit			FU15525
315	1	Adapter board			FU06513
317	1	Insulation Film			FU15528
320	1	Power Modul			8612075-1
325	1	Main Switch			8011032
330	1	Bulkhead Case sealed incl. Female Insert and Wires 3,7 to 6,5 kW	6B EMV		8016292C
345	2	Transverse Bow			8016313
350	1	Bulkhead Case sealed incl. Female Insert and Wires 15 kW	10B EMV		8016293C
370	1	Mains cord cpl.	32 A / 400 V 5m		8750256
375	1	Cord	4G2,5x5m		8750255
380	1	Cord Gland	M20x1,5 7-13		8804020
385	1	Mains Plug	CEE 32A/400V		8032005
388	1	Motor Cord AC/DC cpl.	4x2,5 ² +5x1 ²		8792511
390	1	Motor Cord AC/DC	4x2,5 ² +5x1 ²		8792501
	1*	Motor Cord AC	4G2,5x5m PUR		8750250
395	2	Contact Shell	10BEMV		8040110
	2*	Contact Shell	10BEMV		8020110
	2*	Contact Shell	6BEMV		8016106
397	1	Protective Hood	CHC10		8016510
400	1	Male Insert with Contacts	3P+5P		8016315
402	1	Axial Male Modul	3P Modul		8040393
410	2	Cord Gland	M25x1,5 11-17		8825151
	2*	Cord Gland	M20x1,5 7-12		8820151
	2*	Cord Gland	Pg16 7-12 EMV		8812160
550	1	Ribbon Cable with Pin Headers	14P		8714014
555	2	Ribbon Cable with Pin Headers	6P		9306150
565	1	Ribbon Cable with Pin Headers	8P		8708014
570	1	Shunt-Strand	2P		8702025
575	1	Adapter cable 16/32 A 400 V kpl.	16/32A 400V		8705254

Spare Parts List Frequency Converter FU15D - Control Unit

POS	ST	BENENNUNG	SACHNR	TYP / DATUM	E.-TEILNR
600	1	Control Unit Case - remote control	remote control		WS80533F
	1	Control Unit Case			WS80533
605	1	Control Board for remote control	remote control		WS80510F
	1	Control Board			WS80510
610	1	Keypad cpl. w. Head Plate and Screws - remote control	remote control		WS80560F
	1	Keypad cpl. w. Head Plate and Screws			WS80560
616	1	Clip			WS80532
617	1	Reducing Nipple			WS80534
618	1	Sealing Cap			WS80536
619	1	Lithium Akku	2x3,7V/2.2Ah		WS80550
620	1	DC socket compl. with litz wires and plug	210 mm length		8057008C
621	1	Cable Strap	3,6x140 sw		8836140
623	1	Potentiometer	10K/0,5W		8610500
625	1	Push Button Switch cpl. w. Fixing Adapter and Contact Element	STOP		8022112
670	1	Rotary Knob with front cap	D23		8923150
680	4	Countersunk screw	M3x16		0403016
687	2	Countersunk screw	M3x6		0403006
690	4	Cross recess cheese head screw	M4x12		0204012
	4*		M4x10		0404010
692	1	Slot. Count. Head Screw	C2,9x9,5		0529095
695	4	Hexagon Nut	M3		1003000
700	4	Medium Washer	3,2x6x0,5 Ms		1803433
702	1	Case Sealing			WS80522
705	1	Socket Header cpl. with Wire	2p		7901302
710	1	Socket Header cpl. with Wire	3p		7901303
740	1	Power Supply	9V/1,4A DC		8009014

* Changed spare parts, no longer included in new machines

All prices quoted are list prices, excluding VAT.

When ordering spare parts, please always state: machine number, quantity, designation, spare part number and, for electrical parts, the nominal voltage (if different from 230 V).

